

**5000 GALLON  
CLARIFIER**  
MODEL JZ5000EBE-CL  
LISTED BY UPC®  
NORTHERN CALIFORNIA

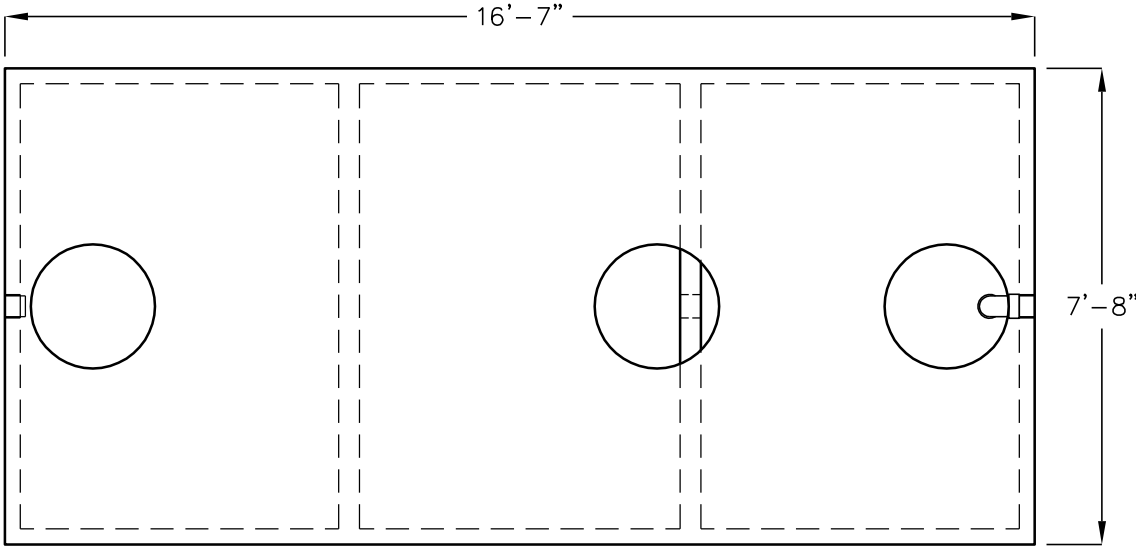

(COVERS AND RINGS REMOVED) **TOP VIEW**

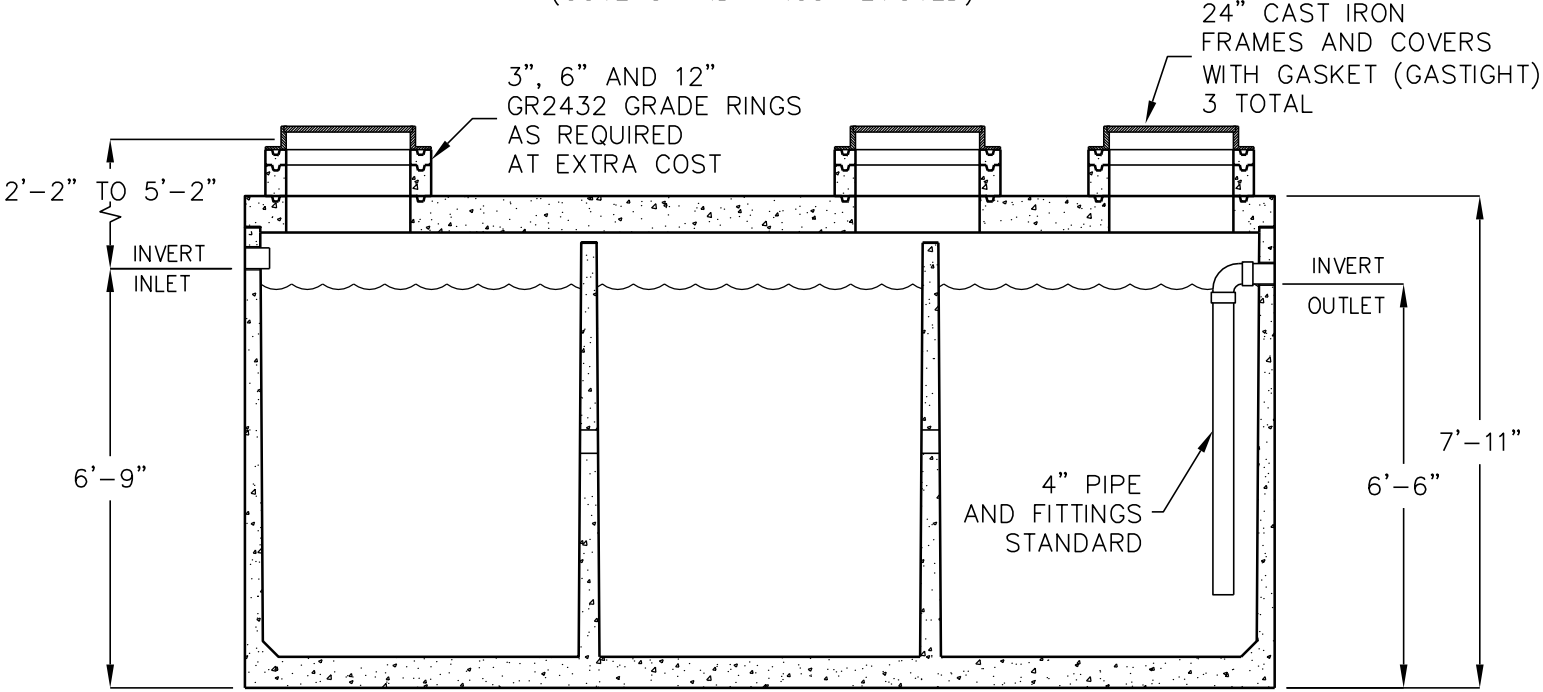

**SIDE SECTION VIEW**

OPERATING CAPACITY: 5,000 GALLONS.  
DESIGN LOAD: H-20 TRAFFIC WITH DRY SOIL CONDITIONS  
(WATER LEVEL BELOW TANK) AND 1'-4' EARTH COVER.

SUITABLE SUB-BASE BEDDED WITH GRANULAR MATERIAL  
SHALL BE PREPARED TO HANDLE ANTICIPATED LOADS.

FOR COMPLETE DESIGN AND PRODUCT INFORMATION  
CONTACT JENSEN PRECAST.

MINIMUM EXCAVATION  
8'-8" x 17'-7"  
x REQ'D DEPTH

