

54" AND 60" DIAMETER REINFORCED CONCRETE PIPE O-RING GASKET JOINT

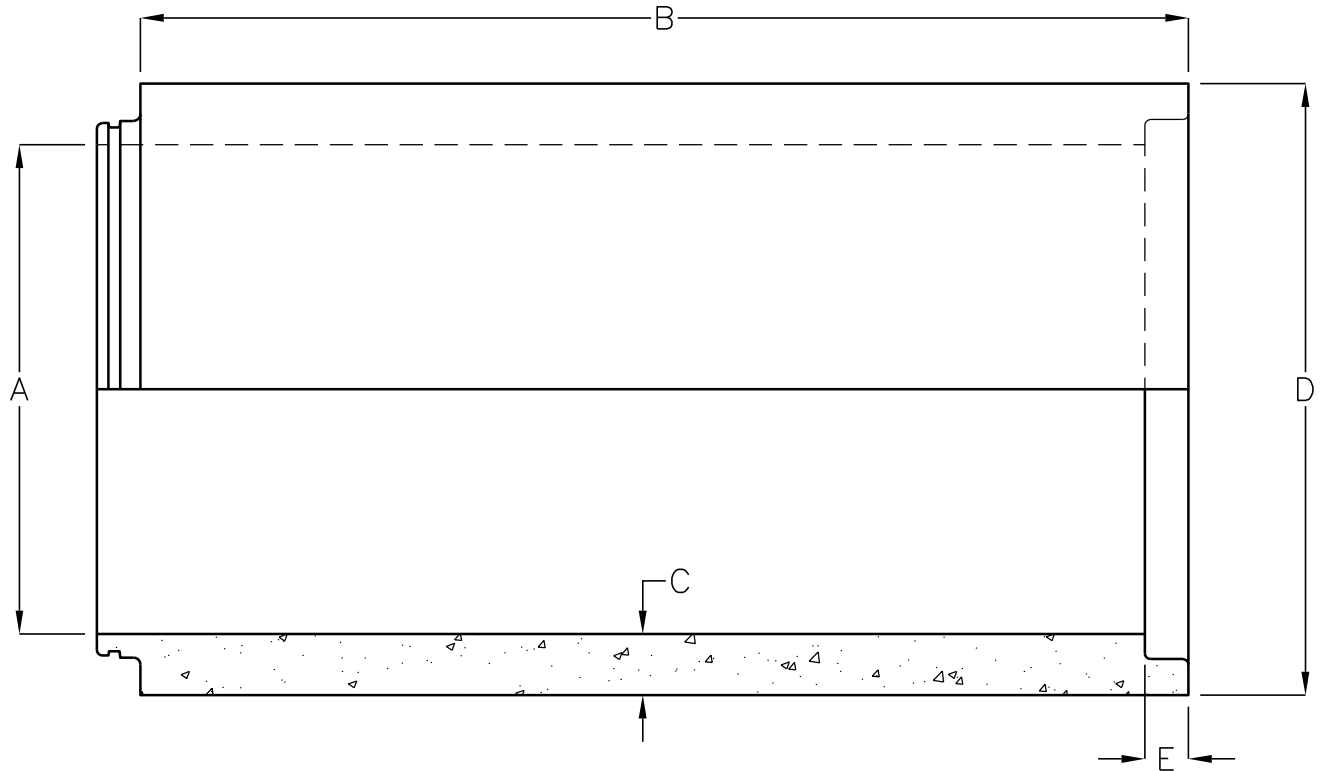

'A' INSIDE DIAMETER	'B' LAYING LENGTH	'C' WALL THICKNESS	'D' O.D.	'E' JOINT DEPTH	WALL TYPE	D-LOAD CLASS	WEIGHT/L.F
54"	8'	6 1/4"	66 1/2"	4 1/4"	C	1000-II	1233 LBS
54"	8'	6 1/4"	66 1/2"	4 1/4"	C	1350-III	1233 LBS
54"	8'	6 1/4"	66 1/2"	4 1/4"	C	2000-IV	1233 LBS
54"	8'	6 1/4"	66 1/2"	4 1/4"	C	3000-V	1233 LBS
60"	8'	6 3/4"	73 1/2"	4 3/4"	C	1000-II	1475 LBS
60"	8'	6 3/4"	73 1/2"	4 3/4"	C	1350-III	1475 LBS
60"	8'	6 3/4"	73 1/2"	4 3/4"	C	2000-IV	1475 LBS
60"	8'	6 3/4"	73 1/2"	4 3/4"	C	3000-V	1475 LBS

REINFORCED CONCRETE PIPE CONFORMS TO ASTM C-76, AASHTO M-170, AASHTO M-198 AND ARIZONA DOT.

FOR COMPLETE DESIGN AND PRODUCT INFORMATION
CONTACT JENSEN PRECAST.